

REFLECTION

FOR LEASE | DOWNTOWN ATLANTA RETAIL/RESTAURANT SPACE



111 JOHN WESLEY DOBBS, ATLANTA, GA, 30303



THE SPACE

Location	111 John Wesley Dobbs, Atlanta, GA, 30303
COUNTY	Fulton
Cross Street	Courtland Street
Square Feet	2,751 SF Divisible to 958 SF & 1,793 SF
Annual Rent PSF	\$37.50
Lease Type	NNN
CTI	\$8.00/SF

Notes Can be subdivided into 958 SF & 1,793 SF

HIGHLIGHTS

- Located in the Reflection Student Housing Community
- REFLECTION© is in the heart of downtown Atlanta and is surrounded by the Georgia State University campus, MARTA Rail & Streetcar Access
- The Building will House 700 Students and Thousands More within Walking Distance
- 26' Clear Height with Ability to Add Mezzanine
- 1,500 Gallon Grease Trap Available
- Ability to install Vent/Exhaust
- Opening the Fall of 2022

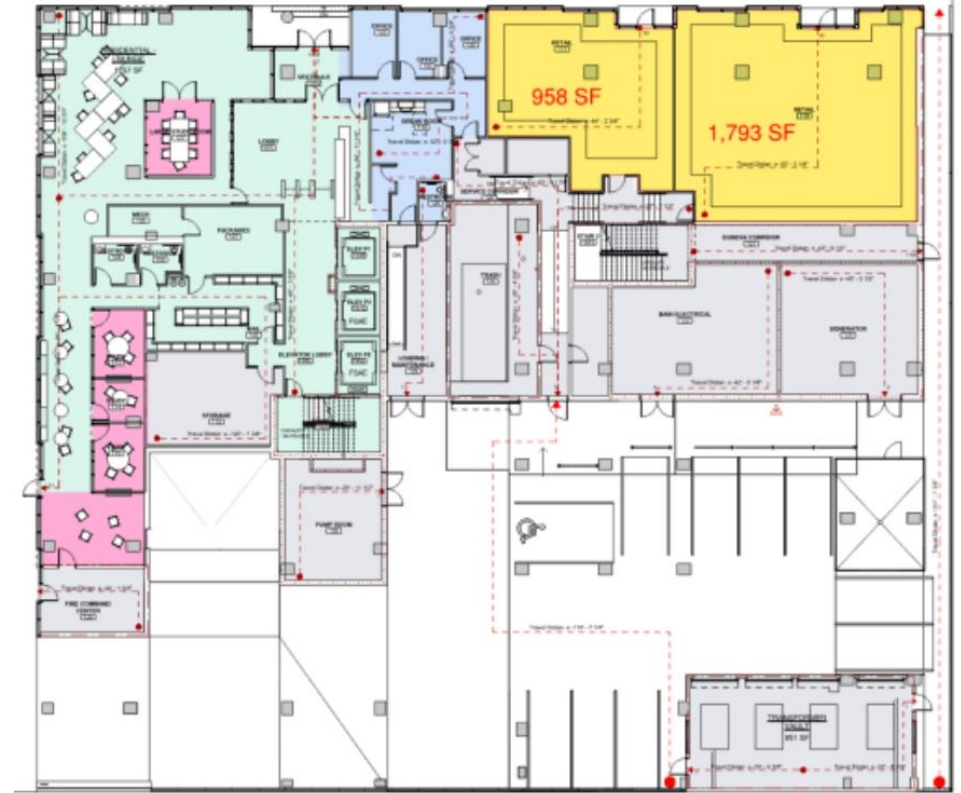

JOEL & GRANOT
COMMERCIAL REAL ESTATE

Dave Smith

404.869.2605

dave@joelandgranot.com

For complete details, please visit: www.joelandgranot.com

633 Antone St NW, Atlanta, GA 30318

(ph) 404.869.2600

